

PROJO S
LED LIGHTING



DESCRIPTIONS

PROJO S Square shape LED Surface Floodlight for outdoor use.
Structure material: Aluminium, beautiful and good self-cleaning effect.

SPECIFICATIONS

Mounting	Surface Mounted
Light Source	CREE
Chip's Qty	16pcs
Material	Die Casting Aluminium
Finish	Akzo Nobel Coating RAL9023
Body Color	Dark Gray
Diffuser	Clear Tempered Glass
CRI	Ra>80
Beam angle	17°, available with different beam angle
Ambient temperature	-20°C ~ +50°C
Average Life Time (Hrs)	50,000 Hrs
Driver Mounting	Built-in
Input Voltage/ Frequency	220-240V, 50/60Hz

PROJO S - Surface Flood Light



APPLICATION

For Outdoor.



DIMENSIONS

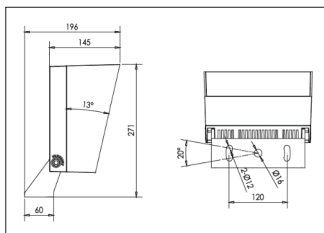

PHOTOMETRIC DATA

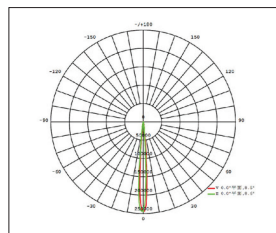

CODE	Wattage	Delivered Output (lm)	Color Temperature	Dimension (mm)	
RAY- PROJO S- FLD - 220- IP66- 80W	80W	6000lm	2700K/ 3000K/ 4000K	as per drawing	N/A

* On/Off built-in driver as a standard, 0-10 and DALI dimmable Driver as an optional.

** the power can be changed upon request.